

You'll need:

Dark red felt

Red felt

Scissors

Elastic cord

Big button (Red color)

2 small red buttons

Needle and thread

Hot melt glue (only adults should use hot melt glue)

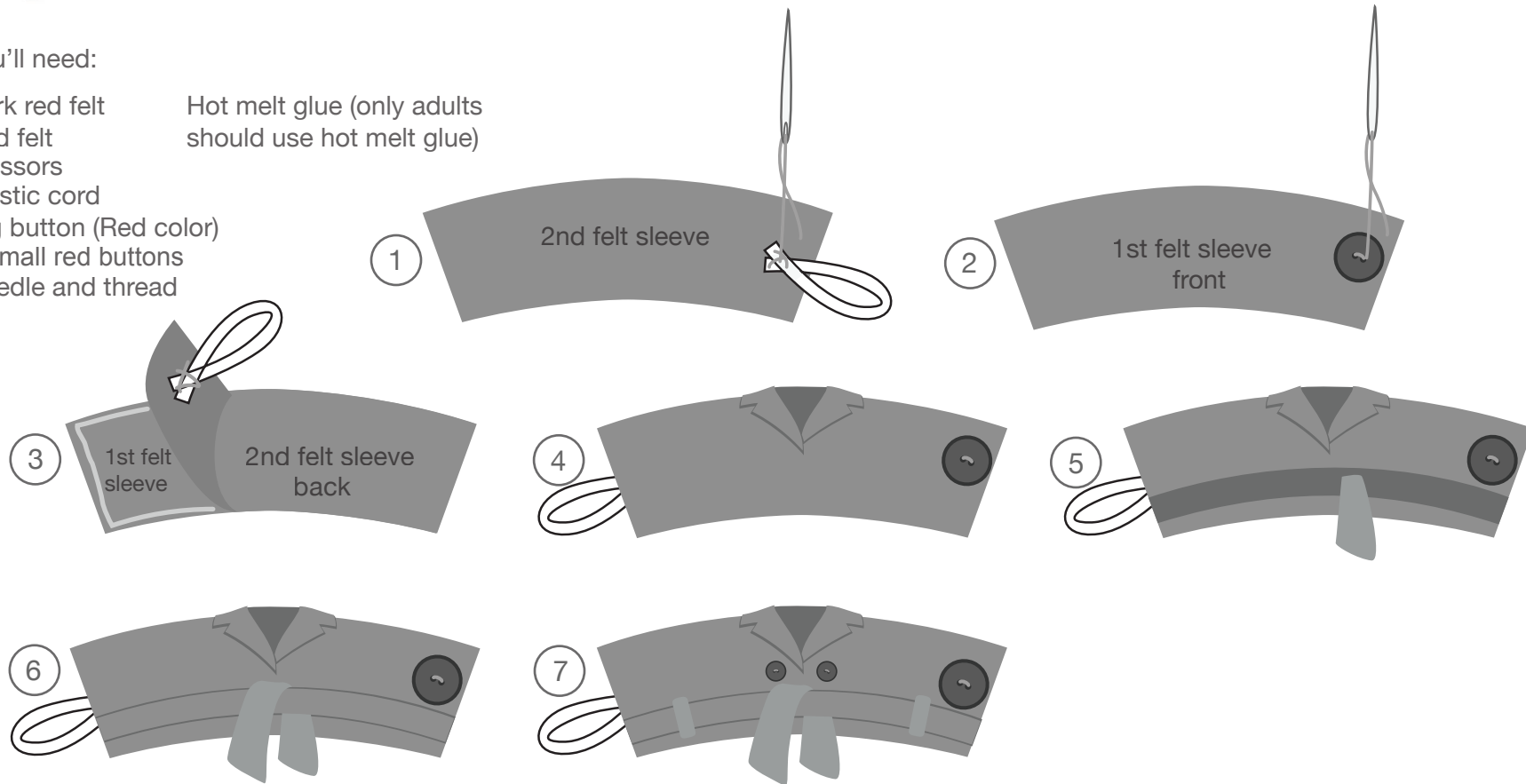

Instructions

Print the template pieces and cut them out. Trace the templates onto the designated color felt and cut out the pieces.

1. Cut a length of elastic cord about 4 inches long. Form a loop with the elastic and sew the ends to the 2nd felt sleeve, on the right end.
2. Sew a button on top of the 1st felt sleeve on the right end.
3. Glue the 2nd felt sleeve with the elastic to the back of the 1st felt sleeve. The sewed elastic ends should be sandwiched between the two pieces.
4. Glue the collar backing to the front, followed by the right and left collars.
5. Glue the dark red belt backing just below the center of the sleeve. Glue right belt strap on top of the belt, center right.
6. Glue the red belt on top of the back belt. Glue left belt strap on top of the red belt, center left.
7. Glue the belt loops, one on the right, one on the left. Sew or glue two small red buttons above the belt, one center right, one center left.

Do not put drink sleeve in the microwave